

# Serene

BY VICINITY



It's human nature to immerse ourselves in  
the natural world.

Serene fulfills that instinct.

**SERENE GREEN WALL**



We believe in the restorative power of  
nature, in an era of gentle and healthy  
living.

**SERENE GREEN WALL**







## Instant Green

Serene offers a lush green surface from day one.

**SERENE GREEN WALL**



## Softer Space

Serene buffers sound, boosts mental health and  
brings a regenerative calm into a space.

**SERENE GREEN WALL**





## Hexa-Fit

There is no waste in nature. The design of Serene is inspired by mother nature - it fits together seamlessly for a lush green wall face - no gaps, just plant perfection.

**SERENE GREEN WALL**

## Fresh Conditions

Serene improves indoor air quality by removing harmful toxins and producing oxygen. The dense quantity of plants also helps to improve well-being and bring a sense of peace.

**SERENE GREEN WALL**



## How It Works

Hidden tanks store water at the base. Water is circulated through a simple irrigation system and then filters slowly down from pot to pot back into the tanks.

**SERENE GREEN WALL**





**SERENE GREEN WALL**



## Smart Tech

Upgrade with an optional remote monitoring device that connects to a mobile app, which sends alerts should there be no power to the pump, or if the water flow stops.

This technology has been custom built to give you piece of mind that your investment is always looked after.

**SERENE GREEN WALL**

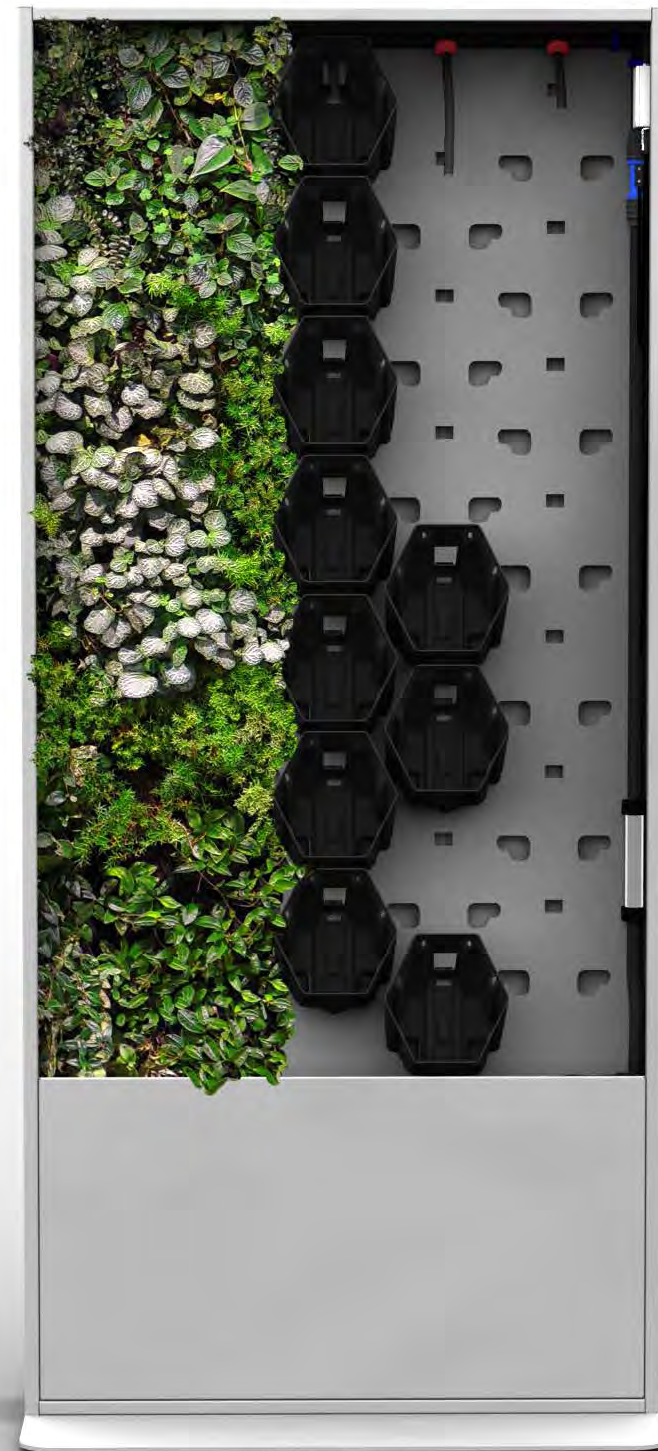



**SERENE GREEN WALL**



## Specifications

The design of Serene is simple and beautiful; made to the highest of quality standards.

## Sizing

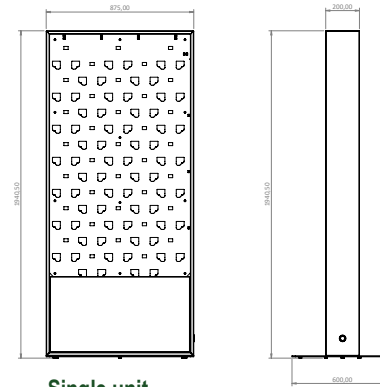

**Single unit**  
(1940mm x 875mm x 600mm)  
Weight - 57 Kg (incl foot plate)

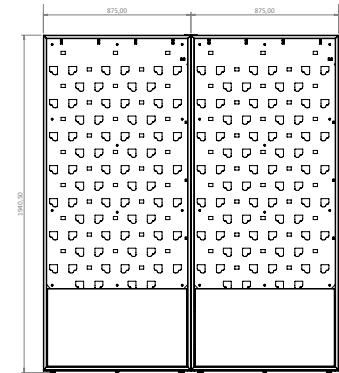

**Double unit**  
(1940mm x 1750mm x 600mm)  
Weight - 114 Kg (including foot plates)

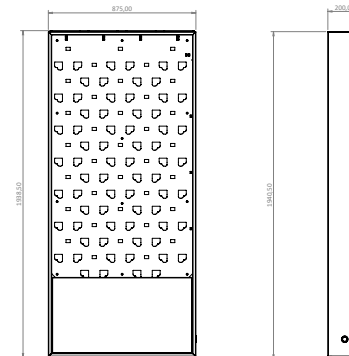

**Wall unit**  
(1940mm x 875mm x 200mm)  
Weight - 57 kg (incl wall bracket)

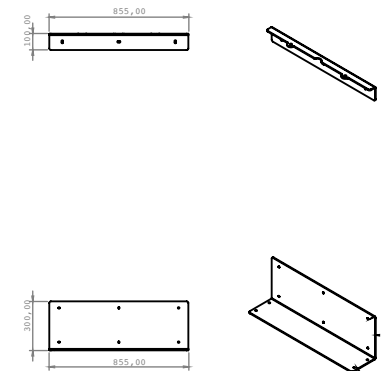

**Wall brackets**  
(855mm x 100mm)  
(855mm x 300mm)  
Weight - 26 Kg

## Finishes

**SERENE GREEN WALL**







Office, Showroom, Hotel,  
Exhibition, Home..

There are endless applications for this innovative free  
standing green wall module.

**SERENE GREEN WALL**





**SERENE GREEN WALL**



It is no coincidence that our systems are  
'unseen' - we seek to enhance plants in  
their most abundant, natural form.

We design for life

**[WWW.VICINITY.ZA.COM](http://WWW.VICINITY.ZA.COM)**